



Gateway Corporate Center

3128 NE 181ST AVE, BLDG A, GRESHAM, OR

FOR SUBLEASE



STEVEN KLEIN
503.221.2260
steven.klein@kidder.com

PETER STALICK
503.221.2272
peter.stalick@kidder.com

GENEVIEVE KLEIN
503.221.2284
genevieve.klein@kidder.com

**Kidder
Mathews**

This information supplied herein is from sources we deem reliable. It is provided without any representation, warranty, or guarantee, expressed or implied as to its accuracy. Prospective Buyer or Tenant should conduct an independent investigation and verification of all matters deemed to be material, including, but not limited to, statements of income and expenses. Consult your attorney, accountant, or other professional advisor.

KIDDER.COM

FOR SUBLEASE

Gateway Corporate Center

3128 NE 181ST AVE, BLDG A, GRESHAM, OR

Building A - ±13,511 SF

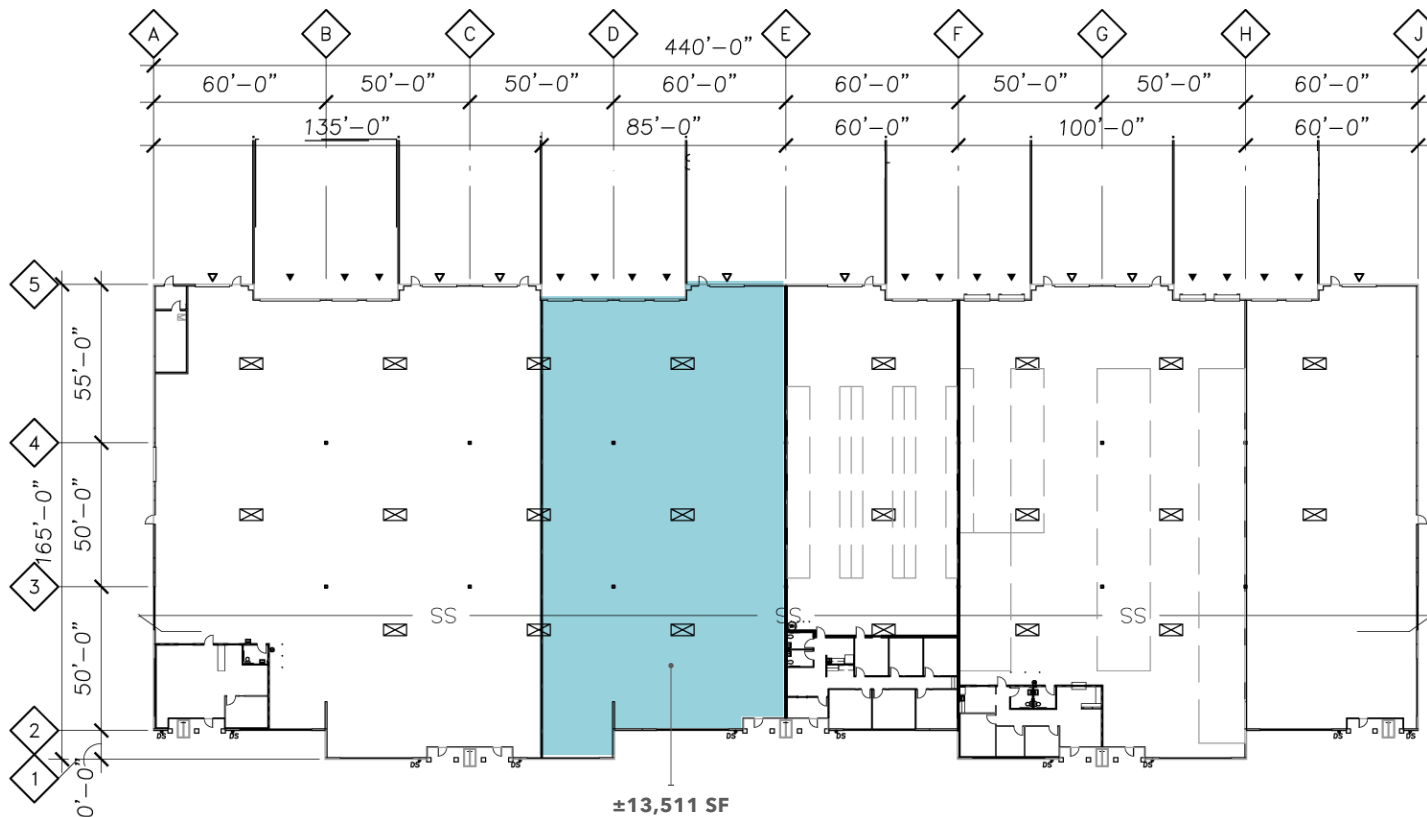

GATEWAY CORPORATE CENTER is a master planned business park located directly adjacent to the 1-84 and 181st Ave freeway interchange, offering unparalleled quick and easy freeway access

±13,511 SF shell

±2,044 SF brand new office space

4 DOCK HIGH loading doors

1 GRADE LEVEL loading door

±24' minimum clear height

NEWER concrete tilt construction

SPACE OFFERS signage and visibility on NE 181st Ave

LEASE RATE call for quote

CURRENT LEASE expires November 30, 2024, Landlord will consider direct lease

STEVEN KLEIN
503.221.2260
steven.klein@kidder.com

PETER STALICK
503.221.2272
peter.stalick@kidder.com

GENEVIEVE KLEIN
503.221.2284
genevieve.klein@kidder.com

KIDDER.COM

This information supplied herein is from sources we deem reliable. It is provided without any representation, warranty, or guarantee, expressed or implied as to its accuracy. Prospective Buyer or Tenant should conduct an independent investigation and verification of all matters deemed to be material, including, but not limited to, statements of income and expenses. Consult your attorney, accountant, or other professional advisor.



FOR SUBLEASE

Gateway Corporate Center

3128 NE 181ST AVE, BLDG A, GRESHAM, OR



STEVEN KLEIN

503.221.2260

steven.klein@kidder.com

PETER STALICK

503.221.2272

peter.stalick@kidder.com

GENEVIEVE KLEIN

503.221.2284

genevieve.klein@kidder.com

KIDDER.COM

This information supplied herein is from sources we deem reliable. It is provided without any representation, warranty, or guarantee, expressed or implied as to its accuracy. Prospective Buyer or Tenant should conduct an independent investigation and verification of all matters deemed to be material, including, but not limited to, statements of income and expenses. Consult your attorney, accountant, or other professional advisor.

km Kidder
Mathews